

KR-series - Underbody cylinder



KRM 145-6-1605-152-G0354-HC

Item no.

R65633152

Tipping weight

15 ton

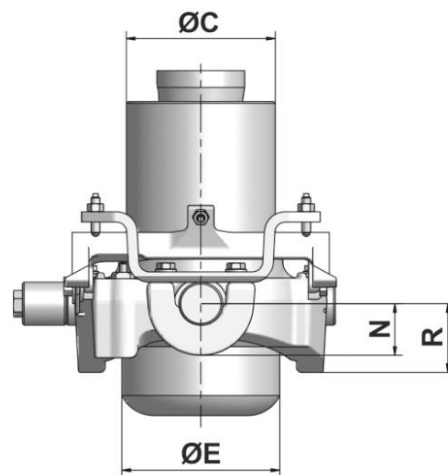
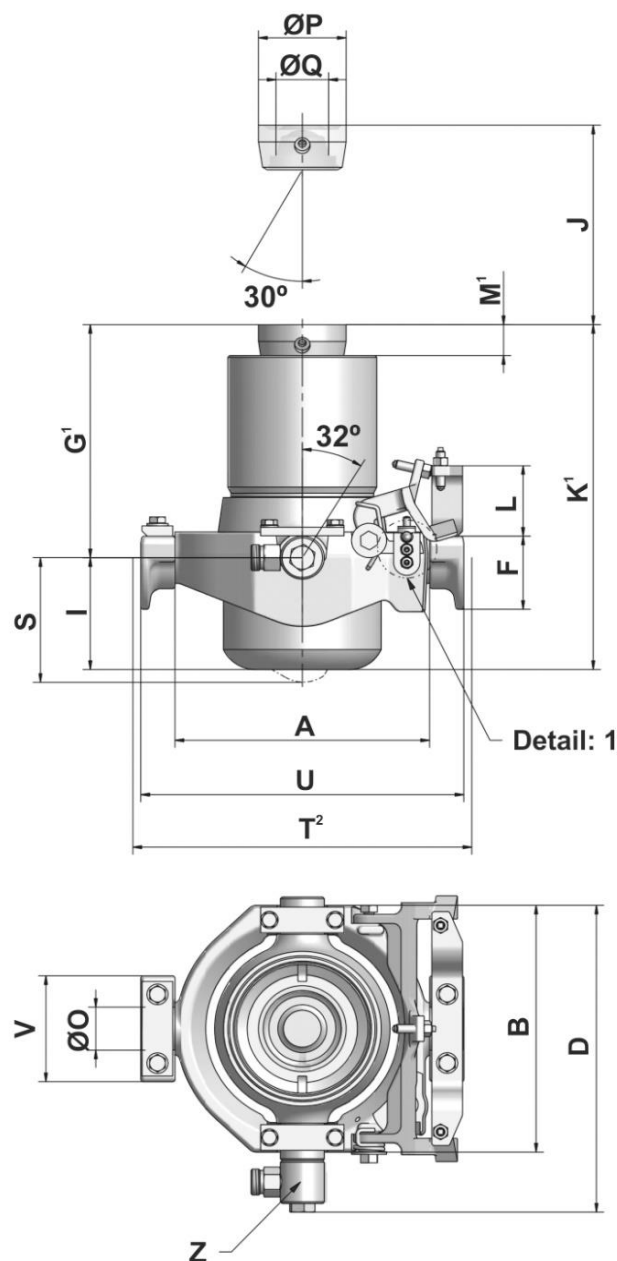

Detail: 1

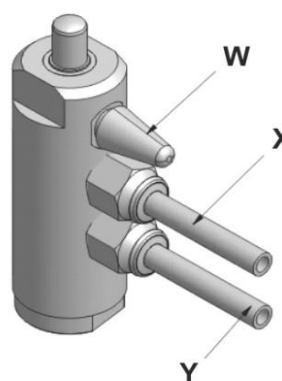

A	290	mm
B	286	mm
C	170	mm
D	359	mm
E	180	mm
F	85	mm
G ¹	354	mm
H		
I	130	mm
J	1605	mm
K ¹	484	mm
L	82	mm
M ¹	67	mm
N	60	mm
O	50	mm
P	100	mm
Q	60	mm
R	80	mm
S	145	mm
T ²	369	mm
U	368	mm
V	124	mm
W	Exhaust	
X	To tipping valve "TIP" (connection for pneumatic line 6x1)	
Y	From air control (connection for pneumatic line 6x1)	
Z	Swivelling pressure connection for tube Ø20 mm	

¹ Including 20 [-5; +30] mm pull out

² Crossbeam distance 369 [-0.5; +1] mm

3D model is available on request

Specifications

Max. working pressure	300 bar	Max. pump flow (with KO)	40 L/min	Cradle type	Cradle type 2
Total weight	96 kg	Max. pump flow (without KO)	29 L/min	Knock off type	Pneumatic
Working volume	14 L	Resulting tipping time (with KO)	21 sec		
Total volume	15 L	Resulting tipping time (without KO)	29 sec		
Max. cyl. load (start tipping)	175 kN	Allowable lowering time	21 sec		KO: Hyva knock off

Extension	1	2	3	4	5	6	7	8	9	Total
Effective diameter [mm]	145	125	107	090	074	058				
Stroke ¹ [mm]	268	275	266	257	269	269				1605

Technical notes

- This cylinder is a lifting device only.
- It should not be used as a structural member and should not be subjected to side loads.
- Tipping valve must have a pressure relief at the cylinder port set not higher than max. working pressure.
- Maximum angle of rotation during operation is 32 deg.
- Working pressure depends on the application, but must never exceed the maximum working pressure stated.
- Working temperature range is between -40°C and +80°C.
- Max. duration of extension is 0.5 hours (excluded hard chromed stages).
- Cylinder is painted black (RAL9005) with a thickness conforming to the 480 hours neutral salt spray test as per ISO 9227 (ISO10289, rating 9).

Related documentation

Bracket options: 015BRA16

Mounting instructions: CYL-0024

Oil specifications: OIL-0011

For detailed tipping calculations please refer to: <https://tipper.hyva.com>

KR-series - Underbody cylinder



KRM 145-6-1605-152-G0354-HC

R65633152

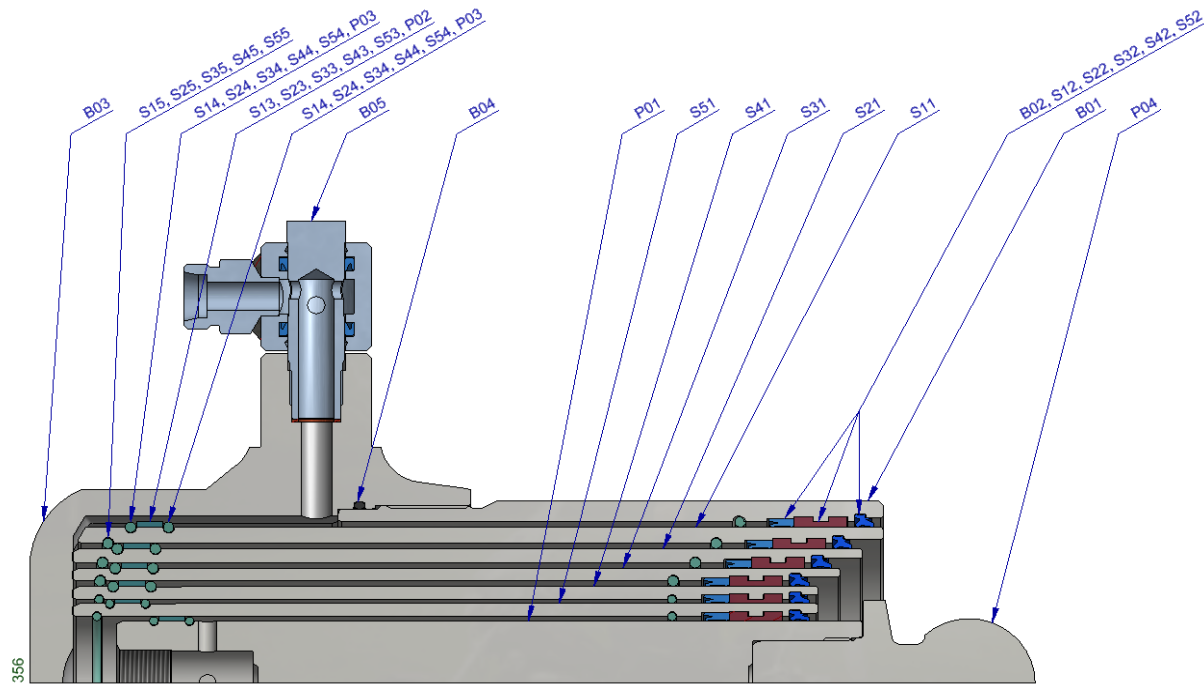

Pos.	Part no.	Description	Qty.
------	----------	-------------	------

P01	76013681	PISTON 058-368-HC	1
P02	75018552 K	SLIDER 58x12	1
P03	G03224421 K	OUTER STOPRING 58x4	2
P04	75024160 K	SPHERE THREAD Ø60	1

S41	75933681	STAGE 090-368-K64-HC	1
S42	75412090 K	PACKSET 090 KRA/KRM	1
S43	75018550 K	SLIDER 90x12	1
S44	G03224655 K	OUTER STOPRING 90x5	2
S45	G03224535 K	LIFTRING Ø 78 X 4 MB	1

--	--	--	--

S31	75943781	STAGE 107-378-K73-HC	1
S32	75412107 K	PACKSET 107 KRA/KRM	1
S33	75018549 K	SLIDER 107x12	1
S34	G00322477 K	OUTER STOPRING 107x5	2
S35	G00322471 K	LIFTRING Ø 95 X 5 MB	1

--	--	--	--

S21	75953881	STAGE 125-388-K73-HC	1
S22	75412125 K	PACKSET 125 KRA/KRM	1
S23	75018437 K	SLIDER 125x12	1
S24	G00322489 K	OUTER STOPRING 125x5	2
S25	G00322482 K	LIFTRING Ø 112 X 5 MB	1

--	--	--	--

S11	75963951	STAGE 145-395-K73-HC	1
S12	75412145 K	PACKSET 145 KRA/KRM	1
S13	75018438 K	SLIDER 145x12	1
S14	G00322498 K	OUTER STOPRING 145x5	2
S15	G03224921 K	LIFTRING Ø 130 X 5 MB	1

S51	75923681	STAGE 074-368-K64-HC	1
S52	75412074 K	PACKSET 074 KRA/KRM	1
S53	75018551 K	SLIDER 74x12	1
S54	G00322452 K	OUTER STOPRING 74x4	2
S55	G00322442 K	LIFTRING Ø 62 X 4 MB	1

B01	75862770	BASE 167-277-K63	1
B02	75412167 K	PACKSET 167 KRA/KRM	1
B03	75018458 K	BASE BOTTOM KRM M165-A219-ZD50	1
B04	G00330967 K	O-RING 165 X 4 NBR 70 SHORE	1
B05	75419020 K	COUPLING SET R20	1

Notes

See 015BRA16 for cradle and bracket spare parts.

Seal kit complete

75420156	Consists of all packsets with packset grease and O-rings	
----------	--	--

The inner stopring is pre-mounted in the grooves on spare stages and pistons. Therefore, when ordering new tubes, it is not required to order stoprings separately.

For repair instructions see: CYL-0034. Serial no. is located on type plate and near type plate support.